

5818 ROUTE 9H & 23 HUDSON, NY 12534

SEPTIC TANKS
 DRY WELLS
 D-BOXES
 CATCH BASINS

**KEELER
 VAULT
 CO.**

STEPS
 CURBING
 WHEEL STOPS
 CUSTOM WORK

PRECAST CONCRETE PRODUCTS

518-851-6281
518-851-9134
FAX 518-851-7835

FROST POST

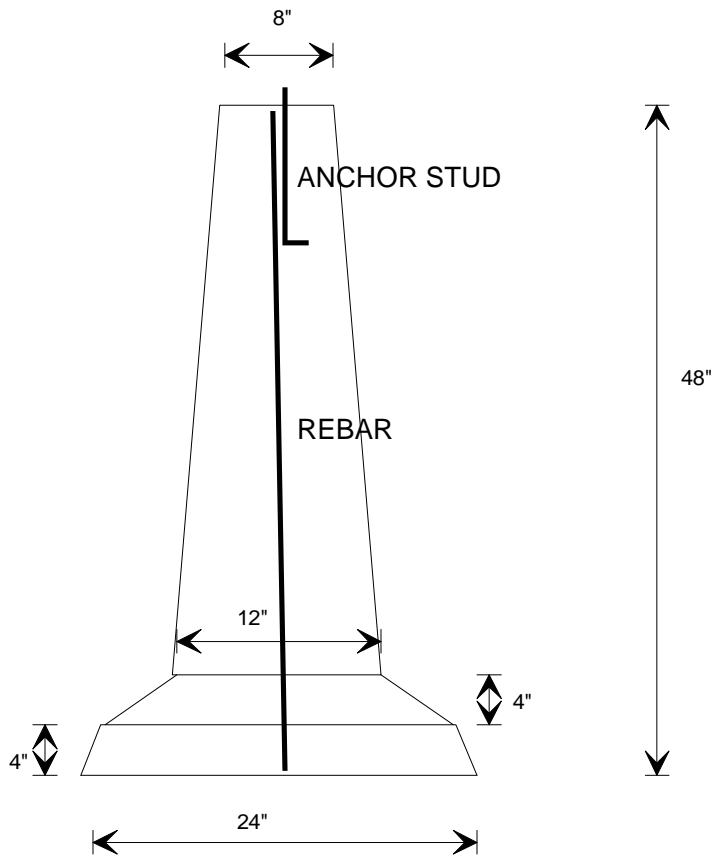

Specifications: Concrete minimum strength-5000 psi at 28 days
 Air entrainment- minimum 5%
 Reinforcement- Euclid Tuf-Strand SF Fiber(6 lbs./yd.)
 3-#3 Deformed Rebar
 1/2" x 12" Galvanized Anchor Stud

WEIGHT: 625 LBS.